

# RHINO™ SERIES TAGS

## HT 3915 ETSI/FCC



Small form factor UHF tag specifically designed for IT asset management. Self adhesive by default but also offers the ability for attachment using cable ties. Optimised for metal, but works on non-metallic objects as well.

## PHYSICAL SPECIFICATION

### Face Stock

Engineering Plastic, Synthetic face film

### Tag Size

39 x 15 x 4 mm | 1.53" x 0.6" x 0.15"

### Adhesive

High performance acrylic adhesive with excellent adhesion to all surfaces

### Delivery Format

Single

### Weight

2.3 g

TOP VIEW

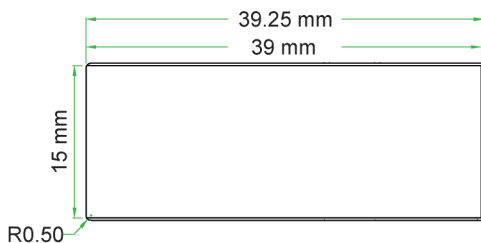

SIDE VIEW

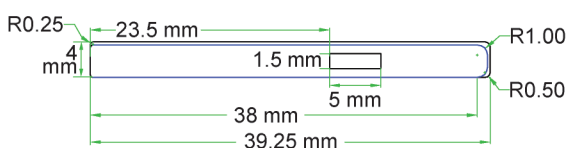

## RF SPECIFICATION

### Air interface protocol

ISO 18000-6C and EPC global Gen2v2 compliant

### Operational frequency

ETSI: 865 - 868 MHz | FCC: 902 - 928 MHz

### IC type\*

NXP UCODE 9xe

### Memory configuration

EPC 128-bit, TID 96-bit

### Read range (2W ERP)\*\*

On Metal Up to 3.6m/ 11.5ft

On plastic Up to 3.8m/ 12.5ft

### Applicable Surface Materials

All Surfaces

## RADIATION PATTERN

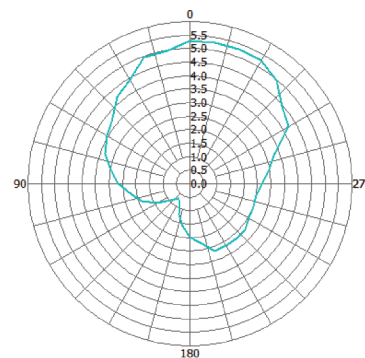

## ENVIRONMENTAL RESISTANCE

### Operating Temperature

-25°C to +80°C / -13°F to +176°F

### Application Temperature

+10°C to 38°C / +50°F to +100.4°F

### IP Classification

IP67

### Chemical Resistance

No physical or performance changes in:

- 168 h Saltwater (salinity 10%) exposure
- 168 h Motor oil exposure
- 12 h NaOH (10%) exposure

### Ideal Storage Condition

1 year in +23°C / 73.4°F, 50% RH

### Expected Lifetime

Years in normal operating conditions

# PERSONALISATION OPTIONS

## Pre-encoding

- Customer specific encoding of EPC memory

## Customized Printing

- Customer specific artwork including logo & text, numbers, barcodes etc.

# ORDER INFORMATION

## Part Number

ETSI: RF.HT.3915.E.U9xe | FCC: RF.HT.3915.F.U9xe

## Packaging

200 Per/Box;  
10 inner/Outer

# PRODUCT INSTALLATION



- Adhesive: The tag is delivered with an adhesive tape attached. While mounting the tag ensure the surface is clean and dry to achieve maximum bond strength. Ideal application temperature is from +10°C to 38°C / +50°F to +100.4°F and installation beyond this temperature range is not recommended. Bond strength can be improved by applying pressure firmly while mounting the tag.
- Cable Tie: HT3915 can also be attached using cable tie. The tag features a slot for passing and securing the cable tie. Metallic or plastic cable ties can also be used to mount the tag onto the surface.

# READ RANGE GRAPH ETSI/FCC

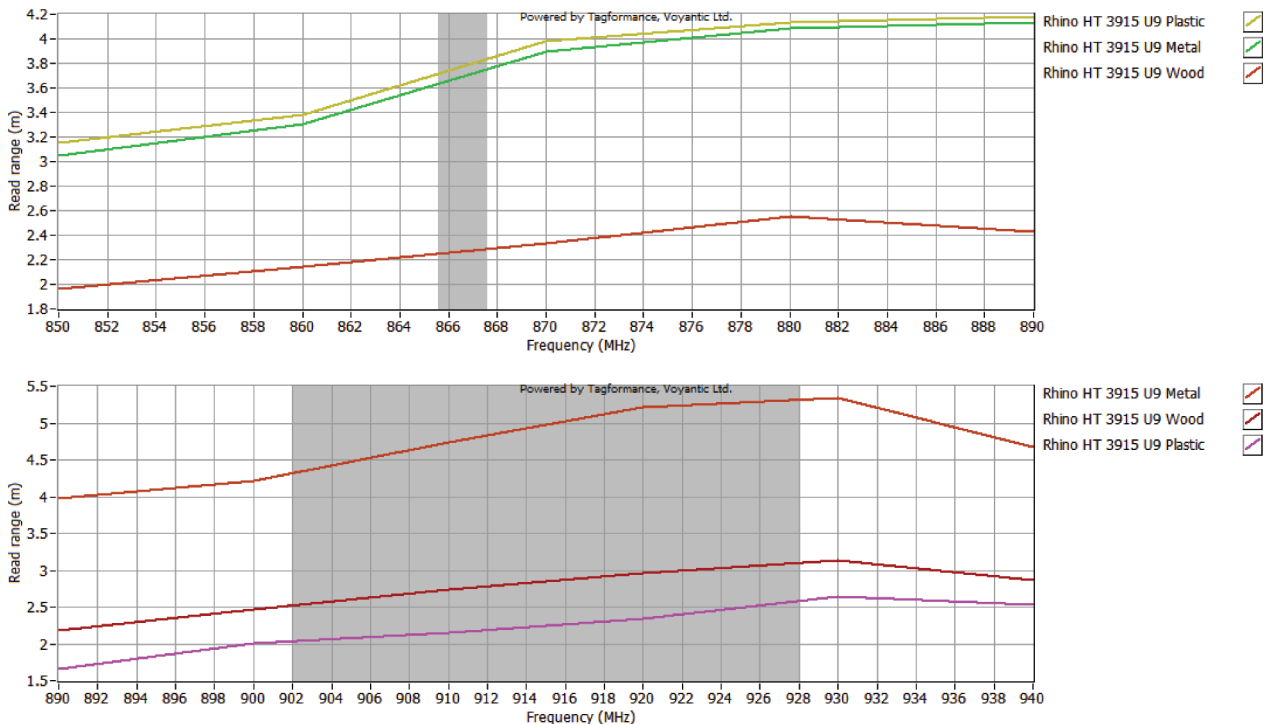

\* Other IC's available on request

\*\* The indicated read range values are measured in our laboratory testing environment, where antennas with optimum directivity are used with maximum allowed operating power. Different surface materials and environments may exhibit different results.